

Date : 2014.02.11.  
From : A.Grava  
Page : 1 / 4

Company :	SERVOLUX SIA	Date :	2014.02.11.
To :		From :	A.Grava
Subject :			
Reference :		Page :	2 / 4

Model :	<b>HRflat 1600 (Weight: 247,1 kg)</b>
---------	---------------------------------------

<b>Filter - G/F</b>					
The heat recovery ventilation unit is equipped with G4 zig-zag filters at the inlet of the polluted air and at inlet of the fresh air, to protect the heat exchanger and guarantee an air quality inside the building. They are easily accessible for maintenance by the access doors equipped with handles.					
				<u>Supply</u>	<u>Exhaust</u>
Filter class :	G4 (Plane Z)	Dimensions :	337 x 965 x 50 mm	Air speed :	1,37 m/s
		Quantity :	1	Filter pressure drop :	25 Pa
Filter class :	G4 (Plane Z)	Dimensions :	337 x 965 x 50 mm	Air speed :	1,37 m/s
		Quantity :	1	Filter pressure drop :	25 Pa

<b>Circular outlet - SR ø 315 mm</b>
--------------------------------------

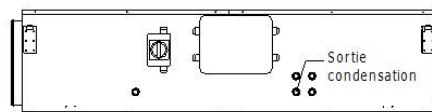
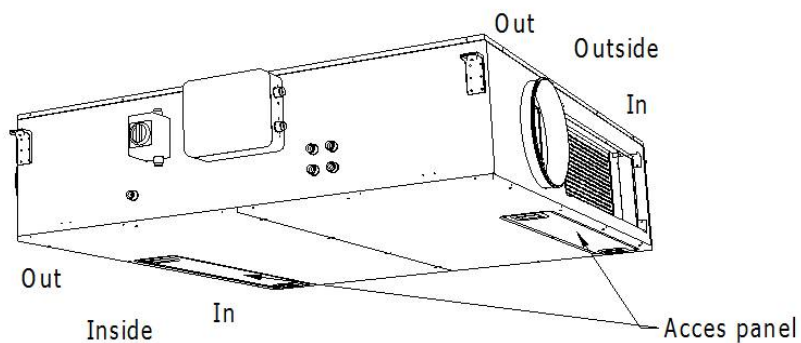
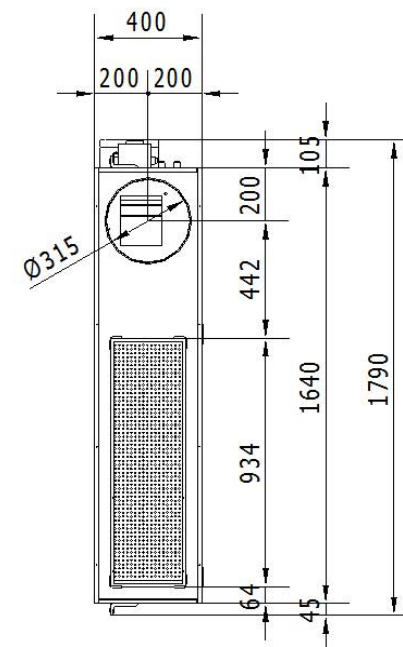
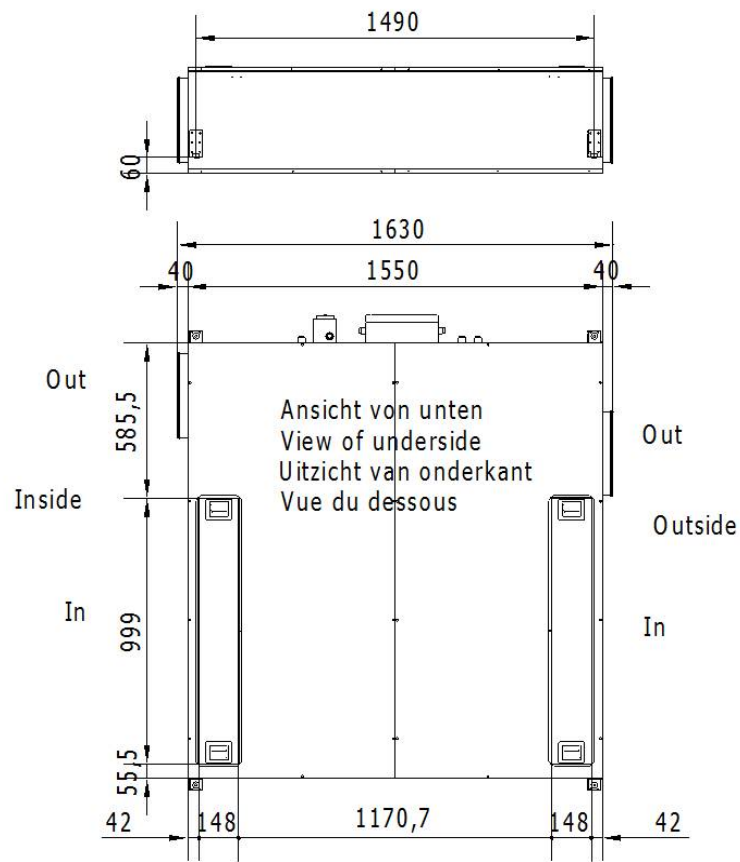
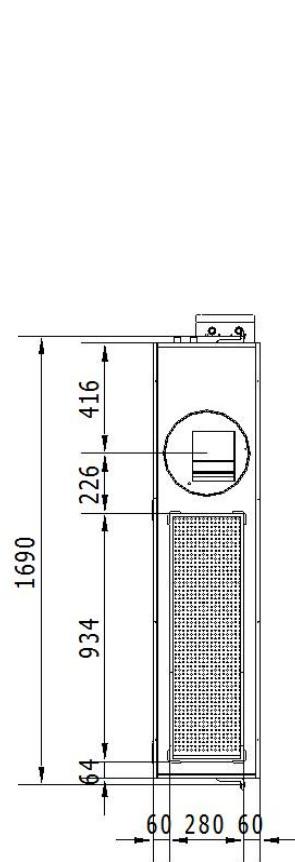

Index	Date	Modification	Par	Contrôle
Index	Date	Modification	By	Controlled
Toutes les cotes sont des cotes extérieures / All dimensions are outside dimensions				
<b>PLEMMENS</b> air movement <i>Company</i>		Titre : Title : HRflat 1600 TAC4 (PLC)		
		Client/Customer : Code client/Customer code:		
Date : 07/03/2012 Unité : mm Dessiné par : M.H.		150 Numéro de plan : Drawing number : 886212		

Company :	SERVOLUX SIA	Date :	2014.02.11.
To :		From :	A.Grava
Subject :		Page :	4 / 4
Reference :			

Model :	<b>HR flat 1600 / BA W</b>
---------	----------------------------

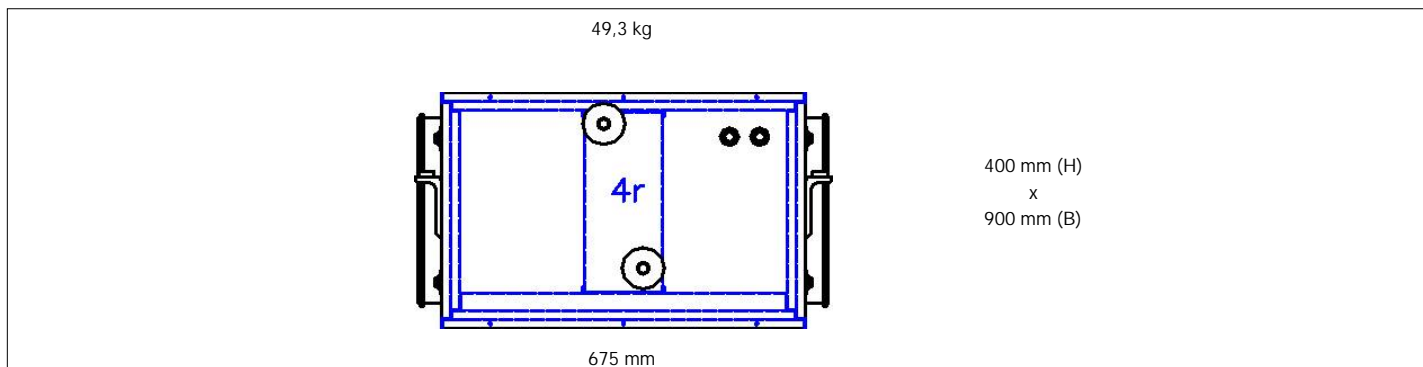

<b>Manufacturing info</b>
882449 / BA W

The BA option is an add-on section to the HRflat unit, equipped with a water or a direct expansion (dx) coil and a drain pan with a condensate pump (230 Vac). The water coil can be supplied with hot or cold water in order to control the supply air temperature to the room. The kit is delivered with the regulation and the temperature sensors used to control the motorized 3-way valve. The latter is controlled by a 0-10V output signal. The 3-way valve is included in the kit. The dx coil is provided without regulation.

<b>Heating coil - NVr</b>				Connection diam. :	3/4"
Coil name :	PAX 800-4	Inlet air T° :	10,0 °C	Fluid type :	Propylen Glycol
Number of rows :	4	Outlet air T° :	20,0 °C	Glycol %age :	35 %
Number of circuits :	8	Airflow :	1600 m³/h	Fluid T° in/out :	80,0 / 17,2 °C
Total capacity :	5,58 kW	Air speed :	2,04 m/s	Fluid flow :	81 l/h
		Air pressure drop :	46 Pa	Fluid pressure drop :	0,15 kPa

Circular inlet - ER Ø 315 mm	Circular inlet - ER Ø 315 mm
------------------------------	------------------------------