

REVIVAL OF HISTORICAL PARKS WITH PERFORMANCE AND TEMPORARY ENVIRONMENTAL OBJECTS

Latvia University of Life Sciences and Technologies university Landscape Architecture students

AGNESE LOČMELE, SALOME RĒDMANE

FINAL CONFERENCE

**A story of interaction of nature, cultural heritage and tourism
in the manor parks**

Eleja, 20.10.2022.

Interreg V-A Latvia – Lithuania Programme 2014-2020

Sustainable Integration of Novel Solutions into Cultural Heritage Sites/ NovelForHeritage LLI-444



Outdoor installations in Eleja park



Interreg
Latvija–Lietuva

European Regional Development Fund



EUROPEAN UNION



"Walk in to the history" The idea was to make Eleja manor owner with his family. Technical solution - the art object is made on the polycarbonate plain. The silhouette is painted with black paint. Elements were hanged by metal wire.



In the picture are owner Paul Medem with his wife Helena. In the other picture is Helenas sister Dina Livena with a dog. When you are walking in the park the silhouettes would create a sense of aliveness.

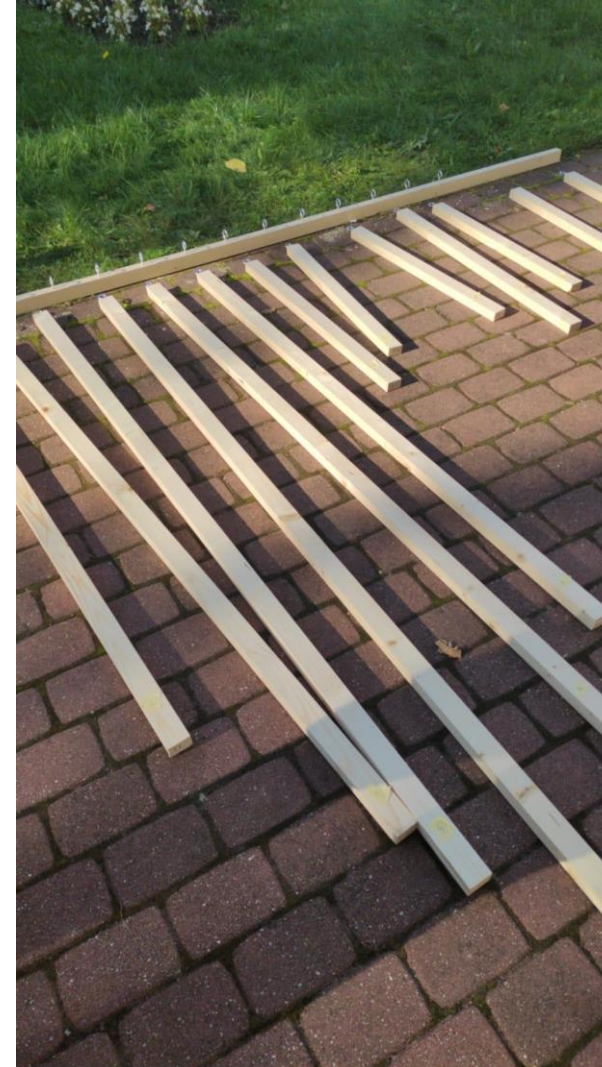
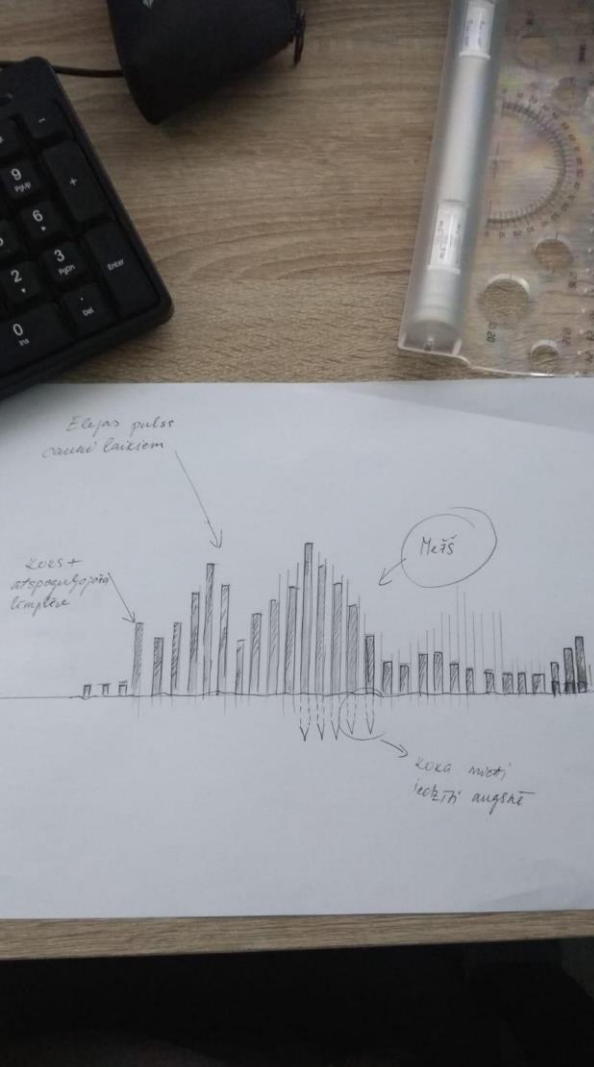

" **The heartbeats of Elejas manor** " symbolizes heart beats of Elejas manor thru the years. At first students planned to make element on the ground, but in the process, group decided to hang it three. Installation is made from wood and covered with metallic tape.



Longest elements reflects the greatest years of Eleja manor and shortest reflects abandonment. Students group also tried to predict the development of Eleja manor. Because of the reflecting tape installation is also integrating in to the environment and by the wind it's moving and creating sounds of the heartbeats, also becoming a music instrument.



Environmental object - " History in net ".

Main object is coins from clay, where on one side are plant prints from Elejas park and on the other side - portraits of people who took a part in Elejas manor house park and its history.



Portraits and plant prints are hanging in frames between two ancient oaks. They are connected with spider web threads, symbolising nets that connects past with nowadays and also great hopes of Elejas manor park future and development, so that it would not be forgotten.





Installation "**Love birds**" symbolizes love letters, longing for love and hopes that was between 16 years old Dagmāra and the hunter. There are around 200 birds made from net plates, stapler and fishing line. In these days couples also come here to have a romantic walk in the park and people are getting married here. This group also had an idea that this could be continued by newly married couples and they could each hand a bird that symbolizes their love.





"Wolf Garden" was created based on the history and historical name of the urban village Eleja. Eleja. In 1923, a new "Meitene" railway station was built and a settlement called Vilkudārzs was established. Technical solution - plywood, adhesive reflective film. Wolf silhouettes was painted with white colour. Inside the box hay was placed.



This aspect of history is depicted in a **wolf howling** scene - where a settlement is being built. In 1932, Vilkudārzs was granted the status of a village. It is depicted as a **wolf crawling** from above, as a strong and mighty village has already developed. In 1936, the village was renamed to Eleja. This aspect of history is depicted in a **wolf sleeping**, because the hard work has already been done and a strong and patriotic community has already developed.

The location of the environmental element was chosen according to the plan of the historical park of Eleja manor, because there was once an orchard on the right side of the manor, so we decided to place the "Wolf Garden" element in this place!



Students vision of exhibition hall

Historical research of the Eleja manor park

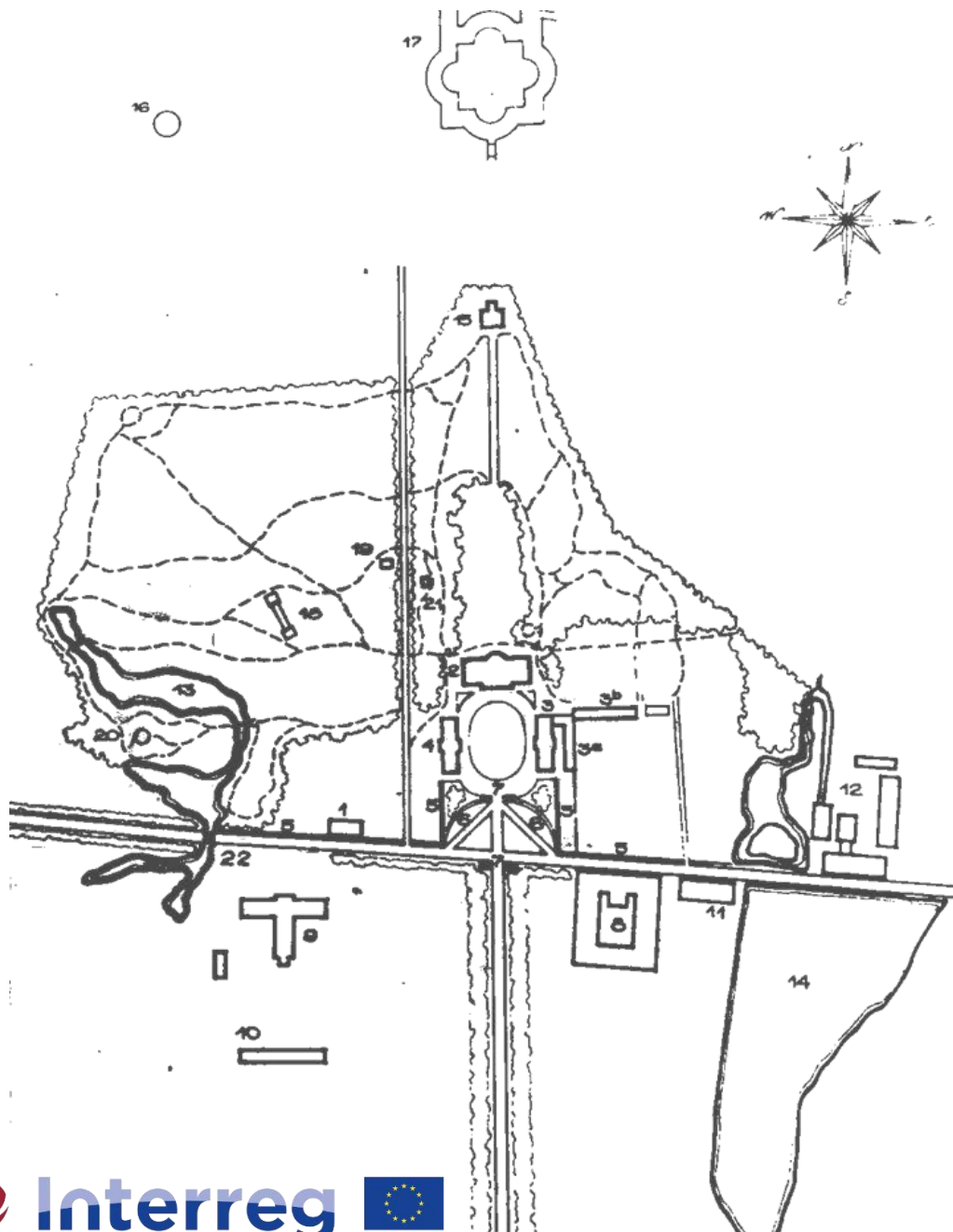

- | | |
|---|---|
| 1. The old residential building | 13. A pond with a peninsula |
| 2. Castle | 14. Brewery complex |
| 3. House of the Manorlord or House of Cavaliers | 15. Tea pavilion |
| 3a. The outbuilding of the manor's house | 16. Round pavilion |
| 3b. Greenhouse | 17. Cemetery |
| 4. Theater building or barn | 18. Pin pavilion |
| 5. Boulder masonry fence | 19. Flagpole |
| 6. The small semicircular fence | 20. Monument to parents |
| 7. 2 pairs of sphinxes | 21. Monument to D. Von Medem
(b. For von Kleist) |
| 8. Cattle barn, later horse stable | 22. Bridge |
| 9. Horse stable | |
| 10. Hay barn | |
| 11. Servants' houses | |
| 12. Brewery complex | |

Vision

The story of Elejas manor where the road starts with the historical, but slowly goes to the modern. At the end of the story, however, it is emphasized / reminded that history is still present with the modern.

It is important to balance the appearance of the external facade with something calmer in the interior - the rooms should be light and in a minimalism style.



A fragment of the ceiling beams of the Elejas tea house with an ornament that could be integrated into the interior of the exhibition hall

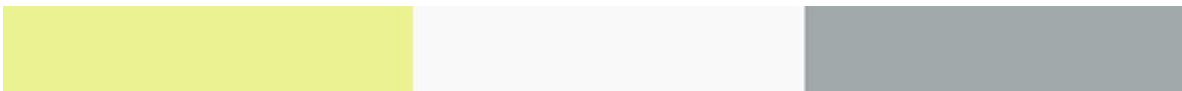

Colour palette



Gras Medem.

Count Medem family coat of arms

- Historical gallery zone
- Variable gallery zone
- Medem family coat of arms

- Conference room
- Elejas park historical plan by G. Kufalt



Color palette

Preservable Tea House Beam

Count Medem family coat of arms

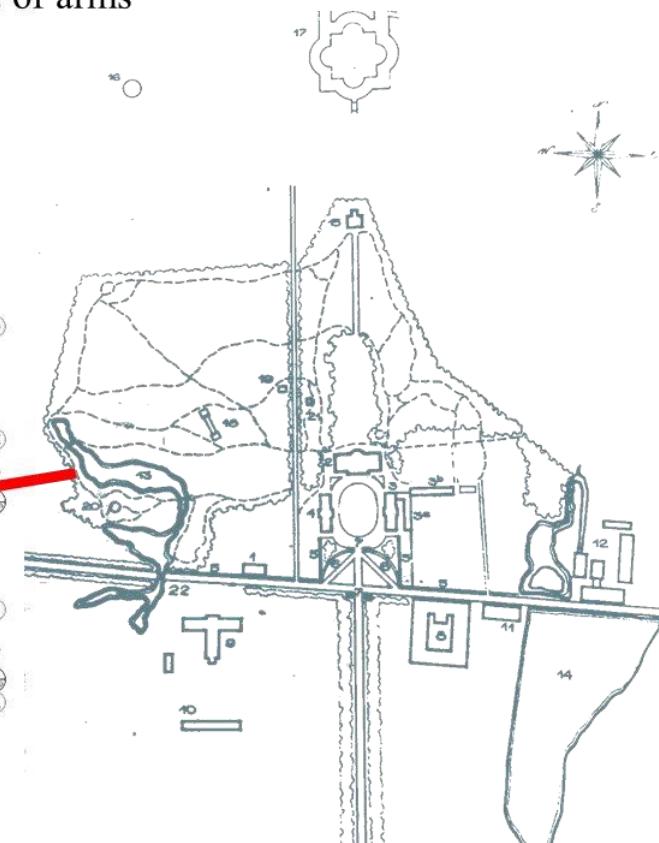
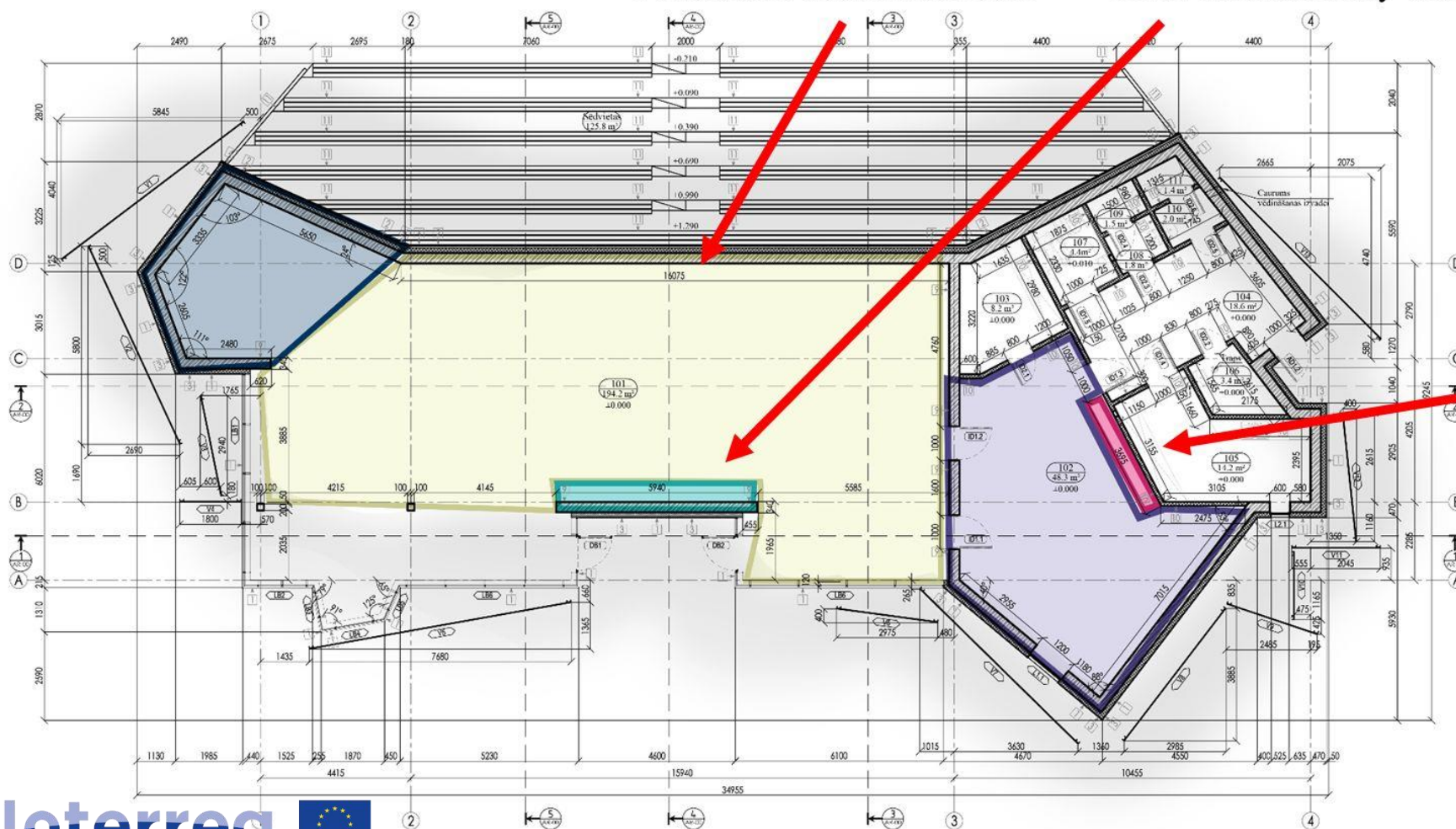

The historical plan of the Eleja manor in a blue-gray tone

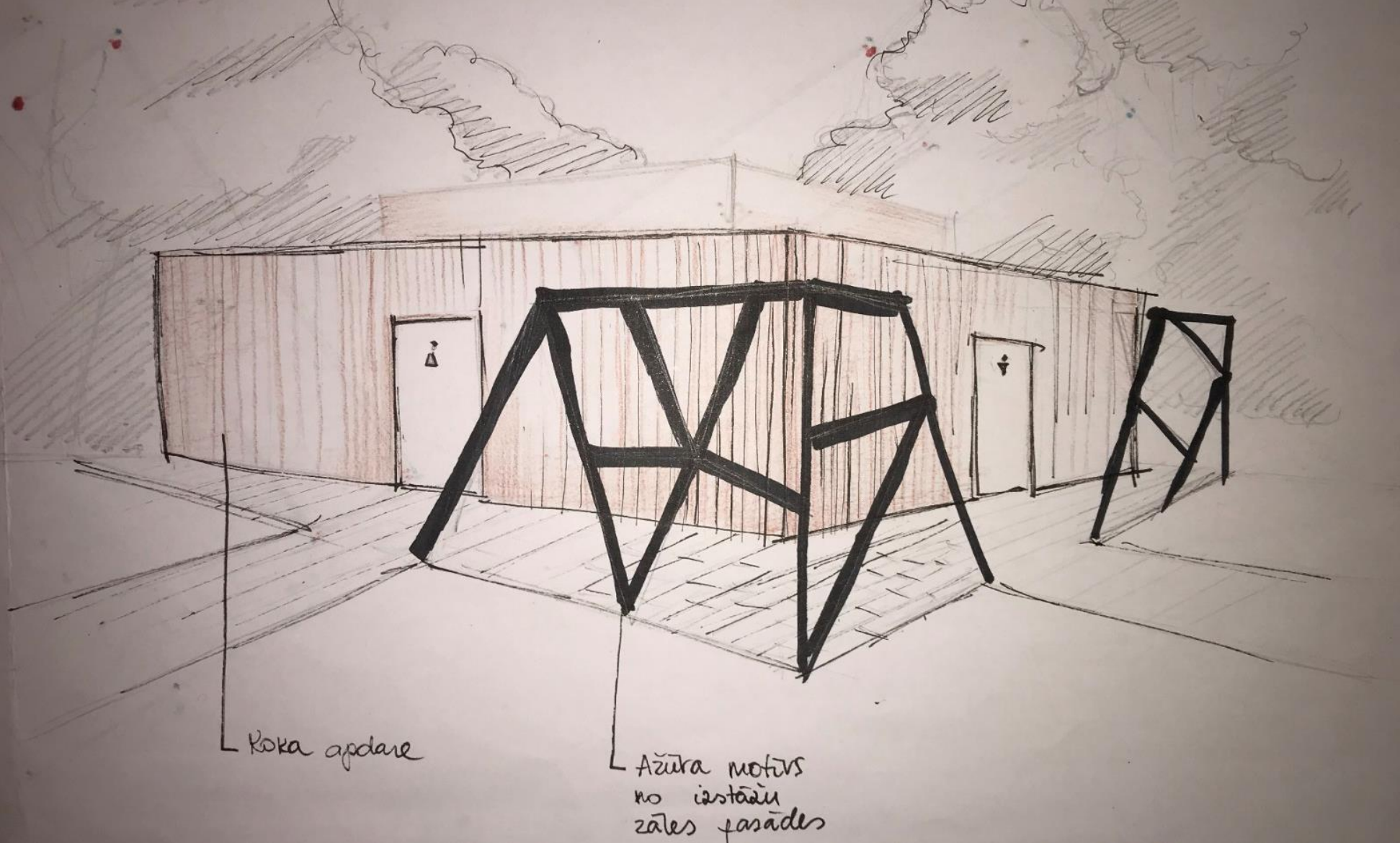

Sketch of the restroom building

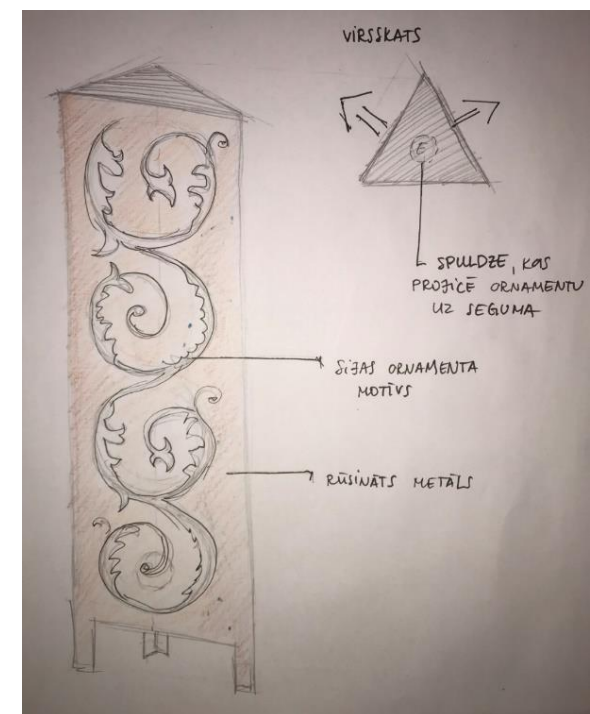

Sketch of the lighting
design element

Pastaiga ar Kūfaltu

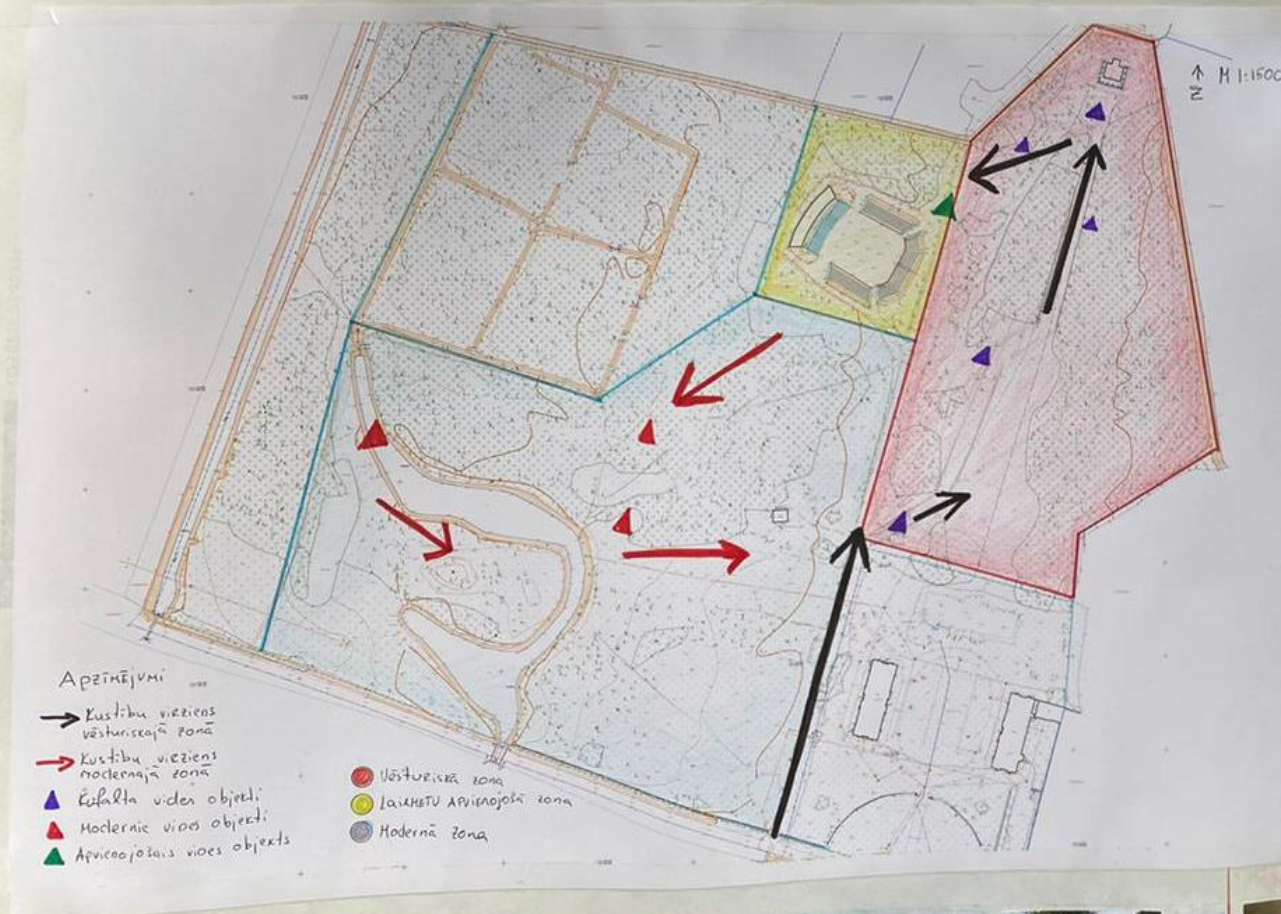

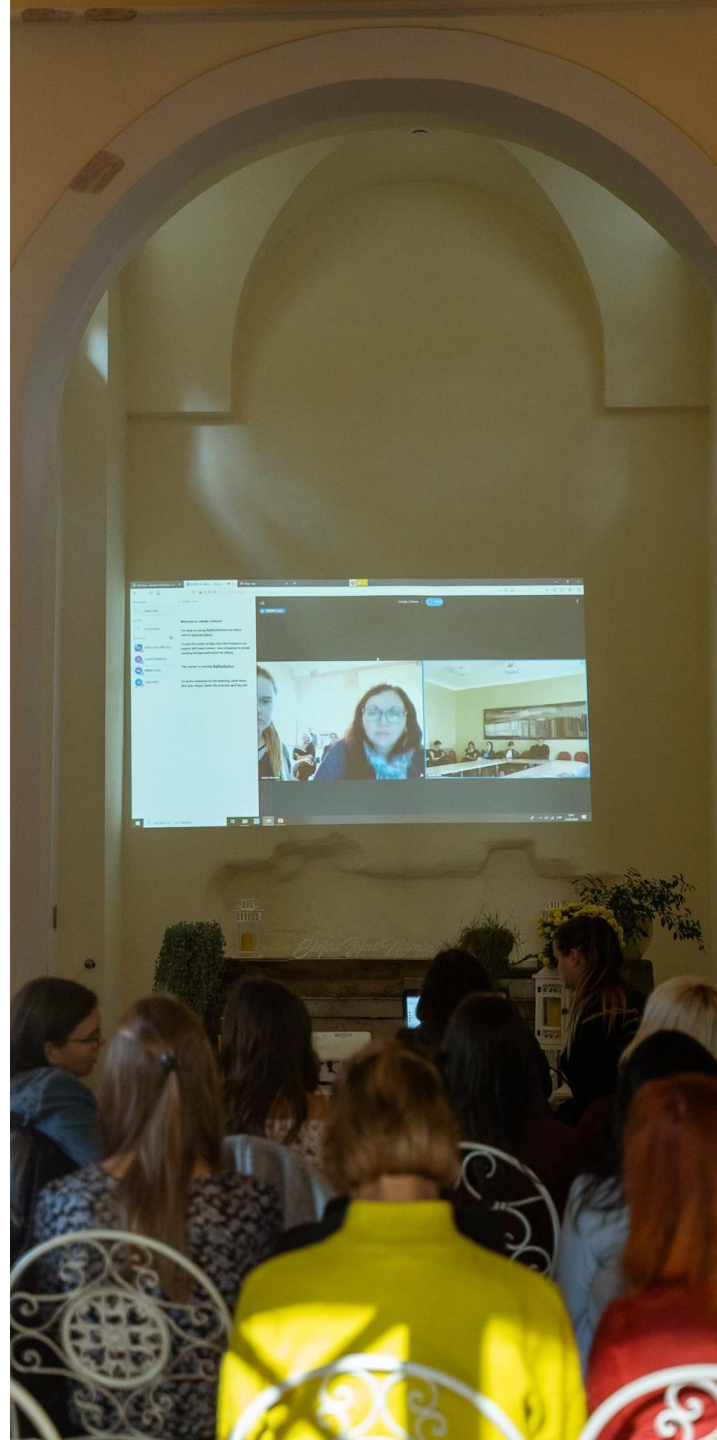

REVIVAL OF HISTORICAL PARKS WITH PERFORMANCE AND TEMPORARY ENVIRONMENTAL OBJECTS

Latvia University of Life Sciences and Technologies university Landscape Architecture students

AGNESE LOČMELE, SALOME RĒDMANE

FINAL CONFERENCE

**A story of interaction of nature, cultural heritage and tourism
in the manor parks**

Eleja, 20.10.2022.

Interreg V-A Latvia – Lithuania Programme 2014-2020

Sustainable Integration of Novel Solutions into Cultural Heritage Sites/ NovelForHeritage LLI-444