

Company :	SERVOLUX SIA	Date :	2014.02.11.
To :		From :	A.Grava
Subject :		Page :	1 / 3
Reference :			

Model :	HRglobal 4000 TAC4 / NVr / MS / CTm / MS / MS / CTm / MS
---------	-----------------------------------------------------------------

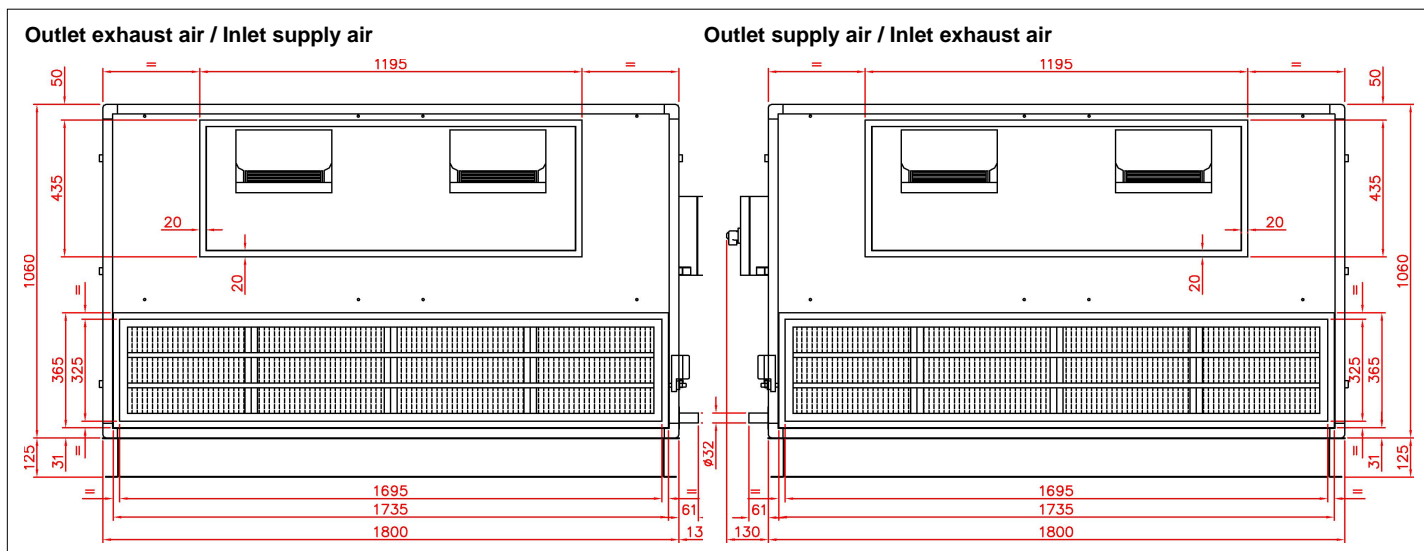
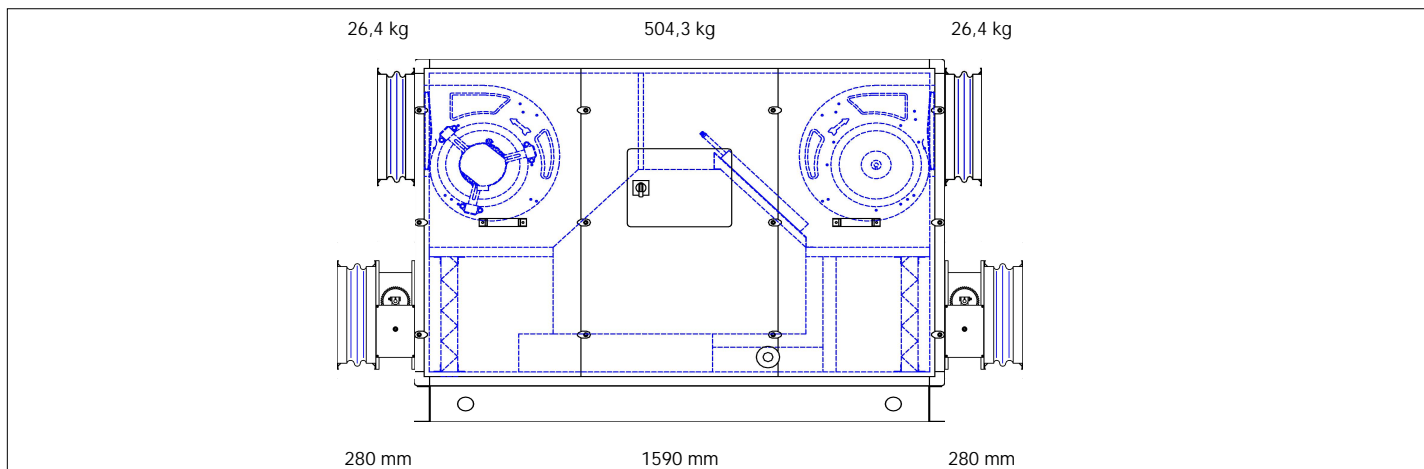

The HRglobal series is a range of mechanical home ventilation units (up to 6000 m³/h) with high efficiency (90 % and more) heat recovery, consisting of aluminium counterflow heat exchangers, a stainless steel drain pan, G4 and F7 class filters and of TAC technology centrifugal fans with high efficiency electronic motors. It will be delivered ready to use, entirely pre-cabled (the options as well) and with a remote control which will allow to control the unit without opening it. All that'll need to be done is to connect the power (outside the unit), to connect the remote control and to set the parameters and that's it ! The device will be delivered as standard with a 100% by-pass, and its pre-cabled control. The new control is designed to receive and monitor the different options available according to your needs. The structure of the unit is in extruded anodized aluminium profile, articulated around strengthened polypropylene modules. Panels are 30 mm double skin. The outside is made of polyester pre-painted steel, and the inside is made of galvanized steel. The heat and sound insulation is made of 28mm fireproofed EPS panels, in conformity with the European standards for the environment. The HRglobal series is mounted on base frame, and is made in one piece (mono block). All the access doors to the fans and filters are equipped with handles. Airtightness of the group allows to classify the device in class 1 for the internal leaks and class 2 for the external leaks according to standard EN 13141-7. A unit with the same characteristics can be offered with all airflow connections oriented upwards. The HRup solution can solve many space availability problems, up to 2000 m³/h. In case of limited height, we can also offer the HRflat range, up to 2000 m³/h as well.

Company :	SERVOLUX SIA	Date :	2014.02.11.
To :		From :	A.Grava
Subject :			
Reference :		Page :	3 / 3

Model :	HRglobal 4000 TAC4 / NVr / MS / CTm / MS / MS / CTm / MS
---------	-----------------------------------------------------------------

Damper(s) - CTm

It 's a damper delivered motorized and pre-wired, to cut the draft during the powering off of the device. It comes with a pre-wired servo motor and is controlled by the regulation. The frame and the aerofoil blades are in galvanised steel, the bearings are in nylon. The external gears, in plastic material, allow a transmission without looseness or deformation.

			<u>Supply</u>	<u>Exhaust</u>	
External dimensions :	365 x 1735 mm	Air speed :	1,86	1,86	m/s
Internal dimensions :	285 x 1655 mm	Damper pressure drop :	5	5	Pa

Base frame - BA**Flexible connection (air in) - MS****Flexible connection (air out) - MS**